

Square PermaWrap® - Installation Instructions

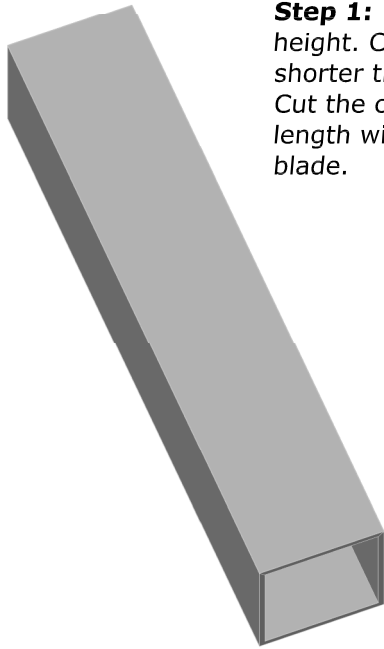

Step 1: Measure the opening height. Cut the column 1/8" shorter than your measurement. Cut the column to the desired length with a fine-tooth carbide blade.

Step 2: Use galvanized or stainless-steel fasteners to secure the squaring blocks to the structural support. Blocking can accommodate a number of installations such as center of the column, inside corner, & inside face of one side.

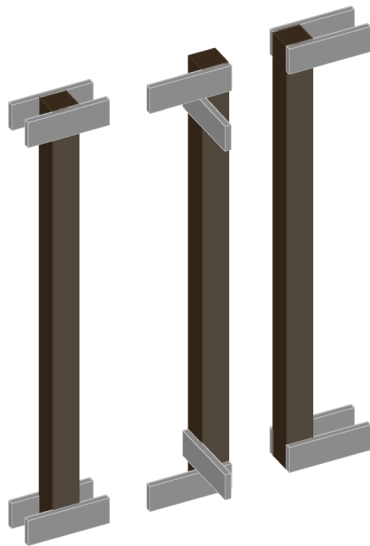

Step 3: Slide the L-shape half around the structural support & position as desired. Secure the half of the column to the post & blocking w/ galvanized or stainless-steel screws or finish nails (screws are recommended because the column shaft can be repositioned if necessary).

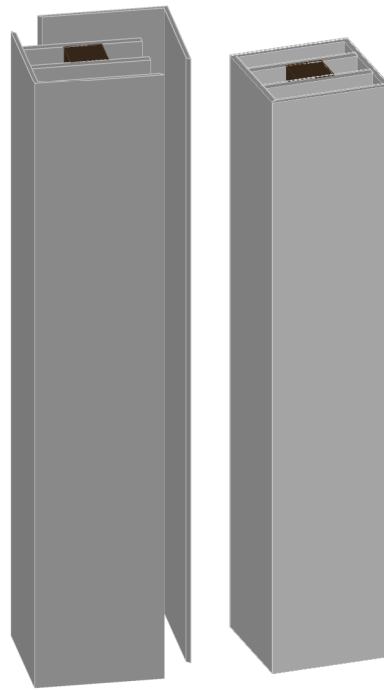
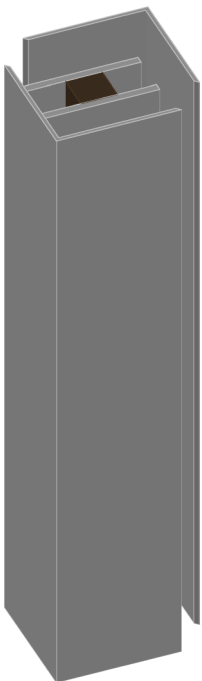

Step 4: Apply a continuous 1/4" bead of urethane adhesive caulk (included) along both mitered edges of the column half. Use a pneumatic finish nailer or stapler to fasten the two halves every 6"-8" along both sides of the column wrap. **NOTE: Clean off any caulk squeeze-out with a clean, damp rag.**

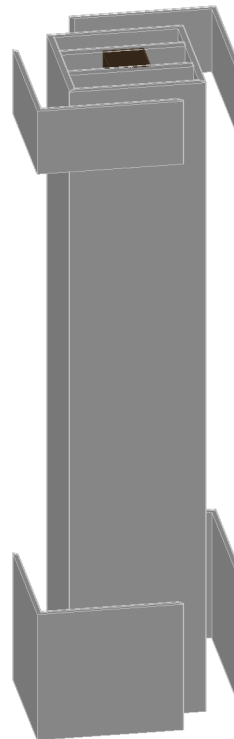

Step 5: Fit the L-shape cap and base around the column. Secure the cap and base with a finish nailer or trim screws.

Step 6: If you want to use the included neck moulding, proceed with fit checking & trimming pieces as necessary. Fasten them using a finish nailer or trim screws. **Note: Use galvanized or stainless steel fasteners. Your Column is Complete. Proceed with the finishing/painting instructions.**

